

### Wheel with mounting flange

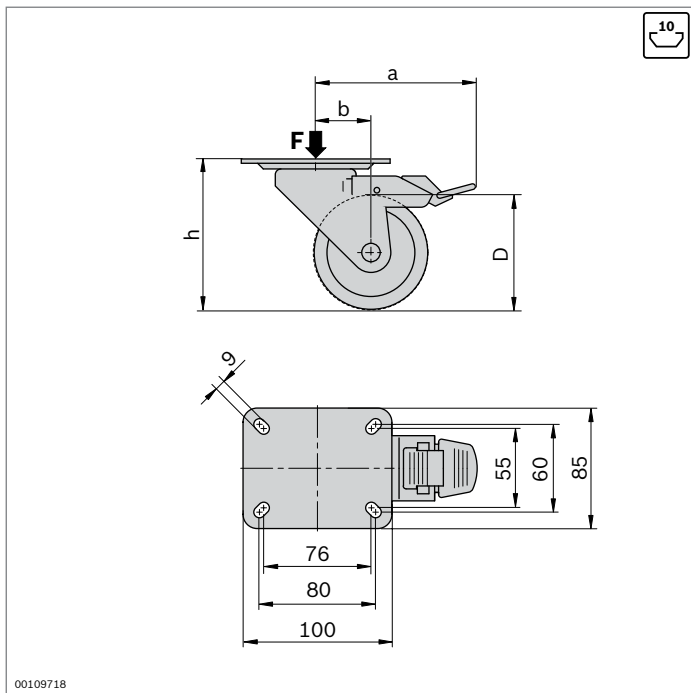

- ▶ Robust rollers with mounting flange
- ▶ Good running properties, particularly suitable for workshop areas
- ▶ Available as a caster wheel with lock and as a trestle wheel
- ▶ Steerable caster with lock: lock prevents the wheel from rolling or turning



Caster wheel	F (N)	D	h	a	b	No.
		(mm)	(mm)	(mm)	(mm)	
	600	100	125	113	36±2	<b>3 842 259 790</b>
	900	125	150	123	40±2	<b>3 842 259 791</b>

Material: Wheel: Solid rubber  
Rims: polypropylene  
Housing: sheet steel; galvanized

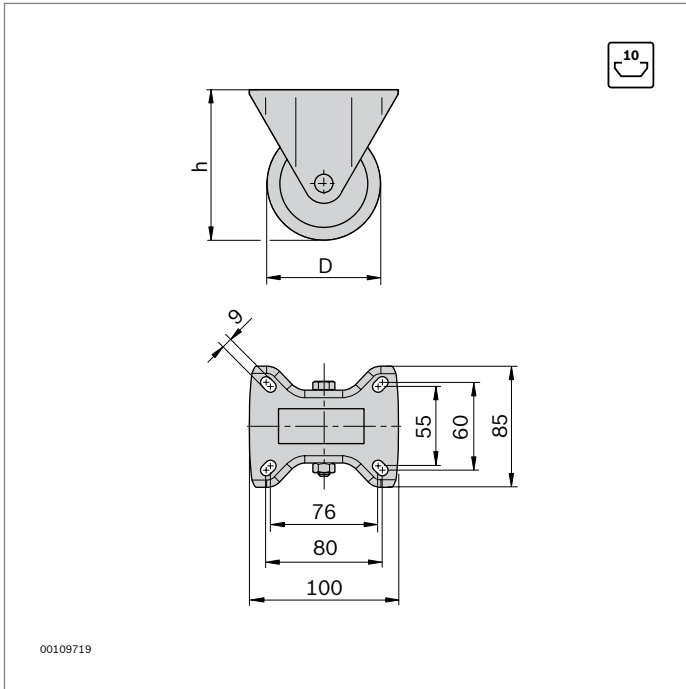

**FS1**

- ISO 4762
- M8x16
- 8-FSt
- DIN 125, 8,4
- M8

Trestle wheel	F (N)	D (mm)	h (mm)	No.
	600	100	125	<b>3 842 259 792</b>
	900	125	150	<b>3 842 259 793</b>

Material: Wheel: Solid rubber  
 Rims: polypropylene  
 Housing: sheet steel; galvanized

Mounting kit	No.	FS
	<b>3 842 259 794</b>	3xFS1